

Experience Oregon Tours

Spring Garden Extravaganza

April 28th to May 1st, 2010



Thornewood
Castle

Highlighting spectacular and inspiring gardens and public spaces, our tour includes a diverse and unique collection of plants, landscape features and cultural heritages. With Tacoma as our home base, our day trips venture in many directions affording us visits to beautiful springtime gardens, art installations, cultural and historical exhibits and performances. Starting with a visit to Portland's Crystal Springs Garden and working our way to Seattle's Carl S. English Jr. Botanical Garden, Hiram M. Chittenden Locks, and the Olympic Sculpture Park, our privately led tours provide beauty, insight and information. Tacoma is abundant with interest and color, and here we visit the 102-year old Victorian Seymour Botanical Conservatory, Point Defiance Park, Union Station, the Chihuly Glass Bridge and Museum of Glass. The European formal-style Lakewold Gardens feature dogwoods, cherry blossoms and a stunning Georgian-style mansion, and is a favorite among garden enthusiasts. And no tour of this area is complete without the *piece de resistance*: Thornewood Castle, a Tudor-Gothic castle nearly 100 years old, where our private tour of the residence and sunken Secret Garden ends with High Tea in the

Great Hall. Throw in a musical performance of Rodgers and Hammerstein's classic *Flower Drum Song*, and we have a trip not soon to be forgotten. From spectacular rhododendrons and azaleas to colorful Chihuly blown glass tulips, this trip is a must for nature, architecture and art lovers. Don't forget your camera and your most comfortable walking shoes.

Day 1: Wednesday, April 28 Crystal Springs Garden

Travel I-5 north to Portland for our first garden stop, Crystal Springs Garden. Regarded as a photographer's dream with one of the world's finest collections of Rhododendrons and Azaleas, this idyllic seven-acre setting is a spectacle of April color surrounding a spring fed lake. Visitors stroll by three waterfalls via two picturesque bridges to Crystal Springs Lake, home to nesting and feeding waterfowl. A specially catered lunch within the garden awaits us. And tonight a special Welcome Dinner is planned at a popular Tacoma waterfront restaurant.

8:00 am Depart Shopko in Eugene. All other departures accommodate this time.

10:45 am Arrive Crystal Springs Rhododendron Garden (pre-select)

1:15 pm Depart

4:45 pm Arrive Tacoma

6:15 pm Depart for special Welcome Dinner

Hotel: La Quinta Hotel, Tacoma

Phone: 253-383-0146

Lunch and dinner included.

Lunch at Crystal Springs Rhododendron Garden requires a pre-selection from the following:

- 1) Chicken salad sandwich
- 2) Turkey club sandwich with bacon
- 3) Tuna salad sandwich



Day 2: Thursday, April 29 Carl English Botanical Garden and Olympic Sculpture Park

Today we drive a little further north where our first stop is the romantic English landscape-style Carl S. English Jr. Botanical Garden. With more than 500 species and 1500 varieties of plants from around the world, this area was transformed from a barren lawn left over from the construction of the adjoining ship locks into a lovely garden in 1931. Adjacent to the garden is the Hiram M. Chittenden Locks which join the Puget Sound to Lakes Union and Washington. A private docent-led tour takes us from the Visitor Center where we learn a bit of history about the facility, to the locks and the fish ladder, and then we are left to our own to stroll the garden and visit the gift shop. Lunch is included at a popular waterside restaurant just a few minutes drive from the Botanical Garden and Locks. After lunch we visit Seattle Art Museum's Olympic Sculpture Park for a private tour. This former industrial site-turned-open-vibrant-green-space for art lies along the waterfront and affords us an opportunity to experience a variety of sculpture in an outdoor setting.



The incredible views and beauty of the Olympic Mountains and Puget Sound provide a most wonderful backdrop to this new park. Dinner this evening can be taken in the hotel's restaurant or you may wish to take a short taxi ride to an area restaurant of your choice.

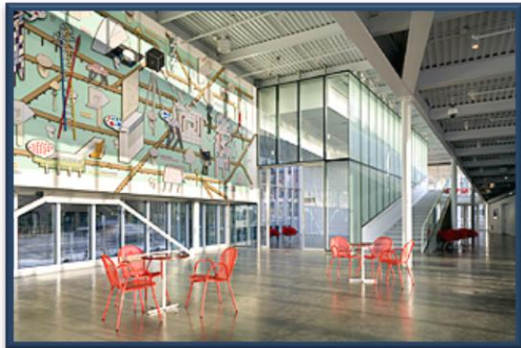

Olympic Sculpture Park

6:00 am	Breakfast service begins
8:45 am	Depart hotel
10:00 am	Arrive Carl S. English Botanical Garden and Ballard Locks
12:00 pm	Depart for lunch
1:30 pm	Depart
2:00 pm	Arrive Olympic Sculpture Park
4:00 pm	Depart for hotel

Hotel: La Quinta Hotel, Tacoma

Phone: 253-383-0146

Deluxe Continental breakfast and lunch included.

Added cost: dinner

Experience Oregon

PO Box 338 ~ Junction City, OR 97448 (541) 342-2662 ~ Toll Free 1-888-342-2662

Print More Itineraries at ExperienceOregon.com/Tours/Extended_Trips.html

Day 3: Friday, April 30 Chihuly Glass, Thornewood Castle, Flower Drum Song

This morning visit Tacoma's architectural crowning jewel: Union Station. Built in the Beaux Arts style in 1911, it has been magnificently restored and today serves as federal courthouse and home to some fine examples of world renowned glass artist, Dale Chihuly's colorful art. From here walk the Bridge of Glass through a tunnel of brilliant light and color created by Chihuly's

glass forms. Linked to the bridge is the unusual cone-shaped Museum of Glass where the Hot Shop houses glass artists at work, there are indoor and outdoor glass displays and we can visit the Museum Shop. Mid-day we travel to Thornewood Castle, a Tudor Gothic Castle nearly 100-years old and over 30,000 square feet. It's building materials were brought around "The Horn" from England and a 400-year-old Elizabethan English manor house was dismantled and shipped to Tacoma to be included in the building of Thornewood. The crystal windows were made in England with stained glass and chards dating to the 14th



Century. Today we are honored guests of the Castle and taken on a private tour of the residence, the sunken Secret Garden" and are treated to a *proper* English high tea. This is an experience not soon forgotten! Enroute back to our hotel, drive through Tacoma's lovely Point Defiance Park where we see saltwater beaches, spectacular views, gardens and old growth forest. Tonight we are treated to a live performance of Rodgers and Hammerstein's favorite *Flower Drum Song*, an enchanting musical set in San Francisco which presents generational differences of old traditions versus new trends.

6:00 am	Breakfast service begins.
9:00 am	Depart for Union Station, Chihuly Bridge of Glass, Museum of Glass
11:40 am	Depart
12:00 pm	Arrive Thornewood Castle for high tea and tour of house and garden
2:45 pm	Depart
4:15 pm	Arrive hotel; dinner at your leisure
7:15 pm	Depart for theTacoma Musical Playhouse
8:00 pm	Live performance of <i>Flower Drum Song</i> begins
11:00 pm	Performance ends

Hotel: La Quinta Hotel, Tacoma

Phone: 253-383-0146

Deluxe Continental breakfast and high tea included. Added cost: dinner

Experience Oregon

PO Box 338 ~ Junction City, OR 97448 (541) 342-2662 ~ Toll Free 1-888-342-2662

Print More Itineraries at ExperienceOregon.com/Tours/Extended_Trips.html

Day 4: Saturday, May 1 Seymour Botanical Conservatory and Lakewold Gardens



We begin our day at the Seymour Botanical Conservatory, an elegant 102-year old Victorian-style landmark filled with exotic tropical plants and floral displays. 300 panes of glass comprise its dome and wings, and inside we should see lilies, hydrangeas, azaleas and more. Not far away is Lakewold Gardens, which, dating back to the early 1900s, began life as a cultured country retreat estate. Designed in the European formal garden-style, each garden “room” was developed to respond to the natural setting and views of Gravelly Lake and Mt Rainier. This ten acre estate

offers historical features, statuary and a stunning Georgian-style mansion. A springtime must-do is the Brick Walk where Mt Fuji cherry trees bloom over flower-filled boxwood parterre beds and dogwoods frame the Teahouse. No visit is complete without a stop at the Garden Shop which was the original 1918 Carriage House. We then continue to lunch at the FallsTerrace Restaurant. Located on the Deschutes River it overlooks the beautiful Tumwater Falls. From here we make our way back to the Willamette Valley and Eugene with beautiful memories of springtime flowers, art and experiences to remember for a long time.

6:00 am	Breakfast service begins
8:30 am	Bags outside your door
9:15 am	Depart for Seymour Botanical Conservatory
10:45 am	Depart
11:00 am	Arrive Lakewold Garden
12:30 pm	Depart
1:00 pm	Arrive for lunch
2:30 pm	Depart
7:00 pm	Arrive Eugene

Deluxe Continental breakfast and lunch included. No added cost.

The total cost of this trip is only \$672 per person double occupancy, **\$798** single occupancy, and **\$631** triple occupancy. Tour price includes: three night hotel including roundtrip baggage handling, three breakfasts, four lunches including High Tea at Thornewood Castle, one dinner, admission to Crystal Springs Rhododendron Garden, private tour of Hiram M. Chittenden Locks and Fish Ladder, private tour of Olympic Sculpture Park, admission to the Museum of Glass, private tour of the residence and grounds of Thornewood Castle, ticket to Tacoma Musical Playhouse’s *Flower Drum Song*, admission donation to Seymour Botanical Conservatory, admission to Lakewold Garden, all Experience Oregon motorcoach transportation and sightseeing per the itinerary, taxes and gratuities for the above mentioned, and services of an Experience Oregon Tour Director. Customary end-of-the-tour gratuity for Experience Oregon escort and driver is not included.

Experience Oregon

PO Box 338 ~ Junction City, OR 97448
(541) 342-2662 ~ Toll Free 1-888-342-2662

Deposit: \$200 per person at time reservation is made.

Payment/Cancellation Policy: Payment is required in full sixty (60) days prior to tour departure, no later than February 28, 2010. If payment is not received by this time, reservations may be cancelled and any waitlisted passenger could be placed in the vacant seat. Cancellations received after final payment date are charged \$100 per person cancellation fee plus any irretrievable payments made to vendors. Cancellations made less than seven (7) days prior to departure including no-shows are non-refundable. Trip cancellation insurance is recommended. Call for details.

Meals: Please call in your pre-selection meal requests when you make your tour reservations. If you have special dietary requirements including vegetarian, it is essential that you let us know at that time.

Please note: Walking is an essential part of this tour so be sure to bring comfortable, rubber-soled shoes. Experience Oregon is not a handicap accessible company.

Luggage: Porterage/baggage handling at the hotel is included so please be sure your name is clearly visible on the outside of your suitcase.

- Trip cancellation insurance is recommended. Call for details.
- Alcoholic beverages are not included in the cost of the meals.
- If travel will require more than two hours, we plan a rest stop.
- While a nametag will be provided to you, wearing the nametag is always optional.
- Please note that all times are approximate and subject to change depending on circumstances of the day.
- Seat rotation will take place.
- We try to accommodate room preferences, but we cannot guarantee the hotel will honor those requests.
- Experience Oregon is not a handicap accessible company. Walking is an essential part of this trip.



Experience Oregon Tours P.O. Box 338, Junction City OR 97448
Phone: 541-342-2662 Toll-Free: 888-342-2662